

QLICKSMART®

...and be safe

H₂HURST
SCIENTIFIC PTY LTD

Qlicksmart **FLASK**

SINGLE-HANDED SCALPEL BLADE REMOVER

As Simple
As
1 - 2 - 3



**OSHA
COMPLIANT**

Do you need to comply to OSHA Regulations?

- OSHA Correspondence:
"In situations where an employer has demonstrated that the use of a scalpel with reusable handle is required..... blade removal must be accomplished through the use of a mechanical device or a one-handed technique... **The use of a single-handed scalpel blade remover meets these criteria.**"¹
- Qlicksmart Flask is the world's first single-handed scalpel blade removal system is OSHA compliant and can be used in all locations that require blade removal.

Why do you prefer the reusable scalpel?

- Weight, feel and ergonomics contribute to this preference.
- Disposable scalpels are flimsy.
- Reusable scalpels have more handle & blade combinations.
- Reusable scalpels with Qlicksmart is 5 times cheaper than disposable scalpels.

Is this a safe choice?

- There is a relative incidence of nearly **twice as many injuries with safety scalpels** compared to the injury rate sustained by staff using reusable handles.²

Features & Benefits

- **OSHA Compliant** (1910.1030)
- Single-handed "passive" activation - **keeping hands out of harms way**
- User friendly - **quick and easy to use**
- Removes blades in a **CLICK**
- Blade fully contained upon removal - **eliminating downstream injuries**
- Device secured at point of use by reusable bracket - making it **easily accessible**
- Use it in hospitals, pathology laboratories, general practice, dental clinics, and **anywhere a scalpel blade is used** (for non-sterile environments)

References:

1. OSHA. 12/22/2005 - Use of passing trays and single-handed scalpel blade remover in a surgical setting. / 2. Sinnott M, Wall D, "SCALPEL SAFETY": How safe (or dangerous) are safety scalpels?, Int J Surg (2007), doi:10.1016/j.ijsu.2007.01.010

Prevention when there is no cure

Scalpel Safety - "The Qlicksmart Method"

Scalpel Blade Removal in 3 Simple Steps

Removal - Containment - Disposal

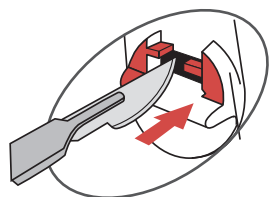

- ① Place blade flat onto landing pad
- Sharp Edge Right, Tang "UP"



- ② Insert scalpel handle into flask
parallel to landing pad - until
pronounced **CLICK**.
(DO NOT FORCE)

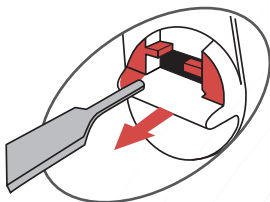

- ③ Remove handle - blade falls
into flask.

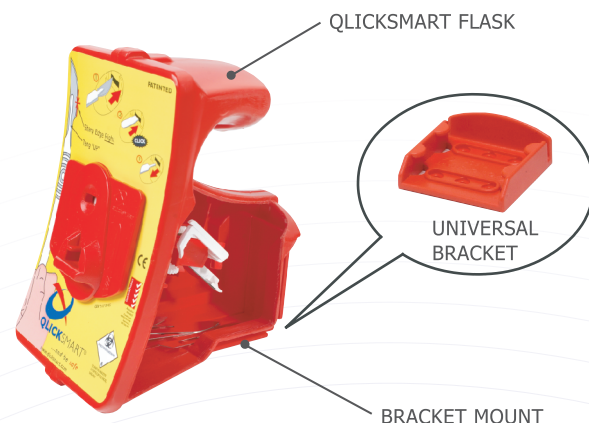

Note: Qlicksmart FLASK is mounted on
Universal Bracket during use.

Qlicksmart FLASK to be disposed of as
medical waste after 100 blades inserted.

Blade & Handle Compatibility

- Qlicksmart Flask has been **tested and is suitable** for use
with blades using the **most commonly used handles**.

Handles: #3, #3L, #4, #4L, #5, #7, #9, Lawton Long
Handle*

Blade sizes:** #10, #10A, #11, #12, #13, etc. up to and
including #25A, #27 and #36

- Qlicksmart Flask can NOT be used with the following
handles: Baron handle, Beaver handle, Disposable handles.

* Some brands may not work with Qlicksmart Flask

** Maximum blade length tested is #36

Adheres to American Safety Standards

- OSHA Bloodborne Pathogens Standard (1910.1030)

For Further Information

